

COUNTY	STATE	PROJECT NUMBER	FISCAL YEAR	SHEET NO.	TOTAL SHEETS
SEDGWICK	KANSAS	###	###	###	###

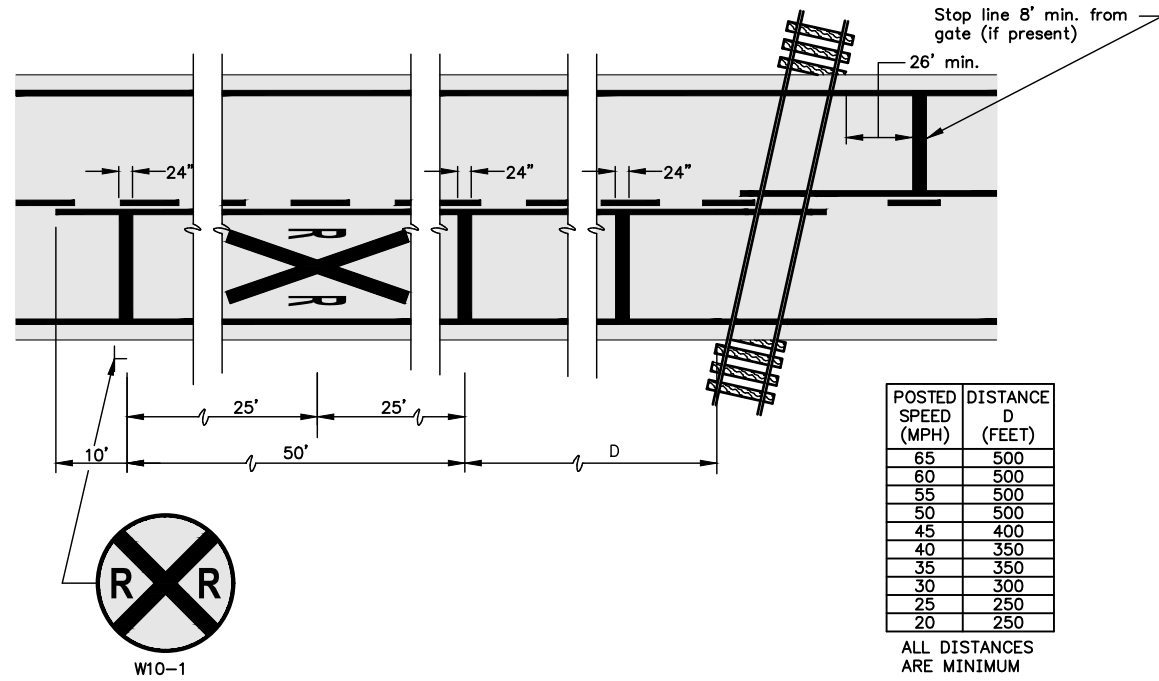

TYPICAL PAVEMENT MARKINGS AT RAILROAD GRADE CROSSINGS  
TWO LANE ROADWAY

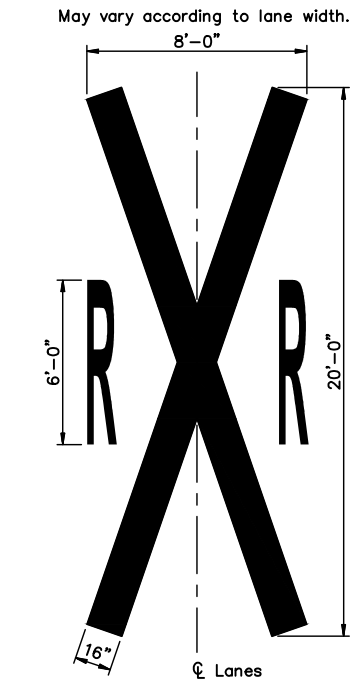

RAILROAD CROSSING SYMBOL

SUMMARY OF PAVEMENT QUANTITIES		
ITEM	QUANTITY	UNITS
Pavement Marking Symbol (Thermoplastic)(White)(RXR)(0.125")		Each
Pavement Marking (Thermoplastic)(White)(24")(0.125")		Lin. Ft.
Pavement Marking Symbol (Methyl Methacrylate)(White)(RXR)(0.125")		Each
Pavement Marking (Methyl Methacrylate)(White)(24")(0.125")		Lin. Ft.

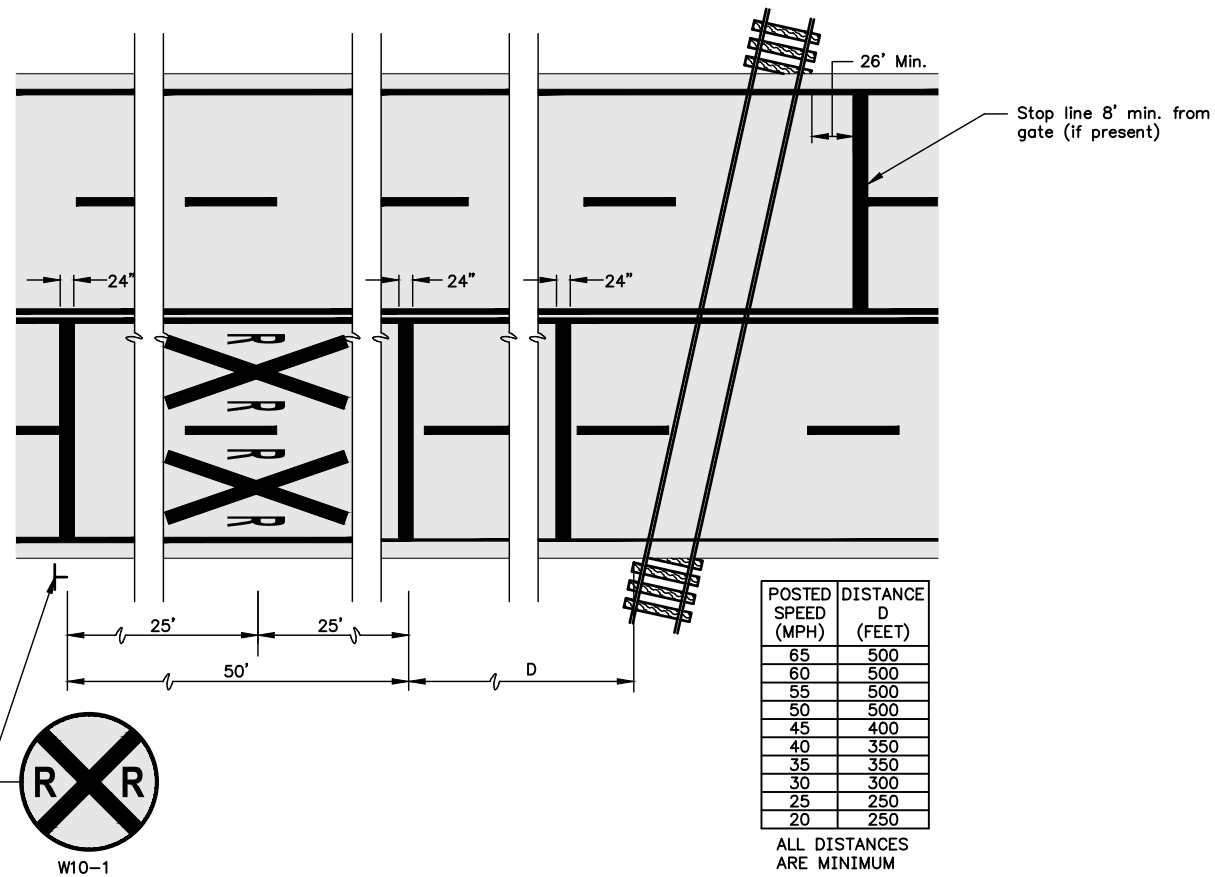

TYPICAL PAVEMENT MARKINGS AT RAILROAD GRADE CROSSINGS  
MULTI-LANE ROADWAYS WITHOUT CURB & GUTTER

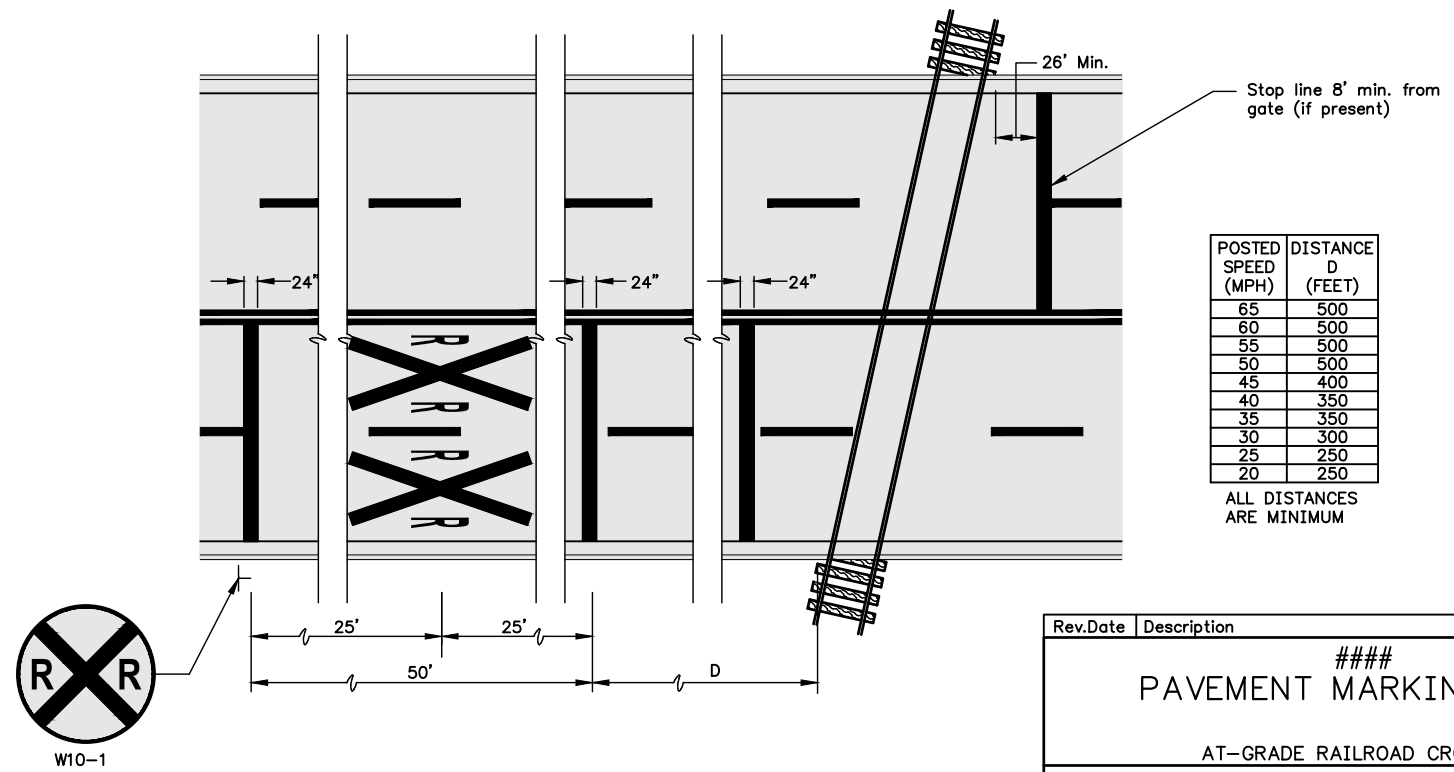

TYPICAL PAVEMENT MARKINGS AT RAILROAD GRADE CROSSINGS  
MULTI-LANE ROADWAYS WITH CURB & GUTTER

Rev. Date	Description	By	Chk
	####		
<b>PAVEMENT MARKING PLAN</b>			
AT-GRADE RAILROAD CROSSING PM 6-0			
PREPARED BY SEDGWICK COUNTY PUBLIC WORKS HIGHWAY DEPARTMENT			
LYNN T. PACKER, P.E.		DIRECTOR/COUNTY ENGINEER	
SCALE	DESIGNED	DRAWN	CHECKED
NONE	M.R.B.	D.R.S.	M.R.B.
DATE	4/2005	4/2005	4/2005
DWS: PM6-0			

Device: AutoCAD PDF (General Documentation).pc3 Page Setup: --- By: Salmans, John  
\\dropw\cad\blocks\STANDARDS\PM6-0.dwg Layout: RRI-0 Plotted: 3/27/2023 1:57 PM