

**Addendum Number Two**  
To The Drawings and Specifications for  
**Red Brick (East and West) Restrooms at Lake Afton**  
**Bid # 24-0071, Sedgwick County, Kansas**

**HANNEY & ASSOCIATES ARCHITECTS**  
1726 South Hillside, Wichita, Kansas

**NOTICE TO BIDDERS**

You are hereby instructed to include in your bids the following changes and/or corrections to the Drawings and Specifications for the **Red Brick (East and West) Restrooms at Lake Afton, Sedgwick County, Kansas**.

The additions and/or corrections shall be considered as a part of the Contract Documents as if incorporated therein. Where the following corrections and/or additions vary from the conditions of the Drawings and Specifications, such following changes or additions shall govern.

**I. GENERAL CLARIFICATIONS:**

- 1.1 The Bid Date and Time shall remain unchanged.
- 1.2 Structural Sheet S200, Detail 21 shall be replaced by the detail below showing full height brick that matches the architectural drawings.

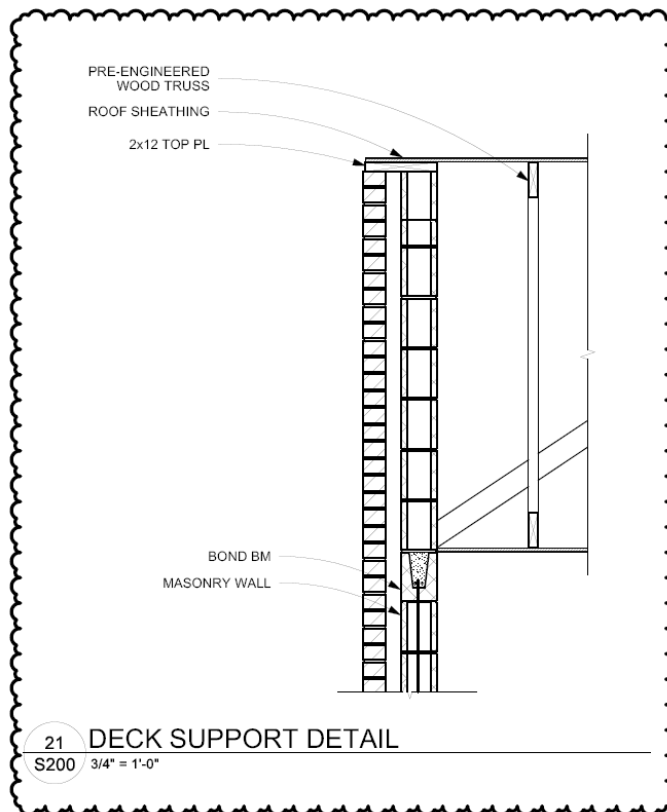

- 1.3 Structural Sheet S200, Detail 12 shall be corrected to look more like detail 3 on sheet A2.2, with the new structural notes.

**END OF ADDENDUM**

**ADDENDUM TWO**