

Device: PDF-XChange For AcroPlot Pro (temporary).pc3 Page Setup: ----- By: Rhein, Jessica J. Q: \Blocks\STANDARDS\Bridg Project Marker-large.dwg Layout: BPM-Large Plotted: 3/24/2025 9:13 AM

COUNTY	STATE	PROJECT NUMBER	FISCAL YEAR	SHEET NO.	TOTAL SHEETS
SEDGWICK	KANSAS	#####	####	####	##

[ROAD] BRIDGE 20

PETER F. MEITZNER
1st DISTRICT

JEFF BLUBAUGH
2nd DISTRICT

STEPHANIE WISE
3rd DISTRICT

RYAN BATY
4th DISTRICT

JAMES M. HOWELL
5th DISTRICT

SEDGWICK COUNTY COMMISSIONERS

LYNN T. PACKER, P.E.

DIRECTOR - SEDGWICK COUNTY PUBLIC WORKS

CONTRACTOR _____

CONSULTING ENGINEERS _____

BRIDGE NO. ____ - ____ - ____

DESIGN LOADING HL-93

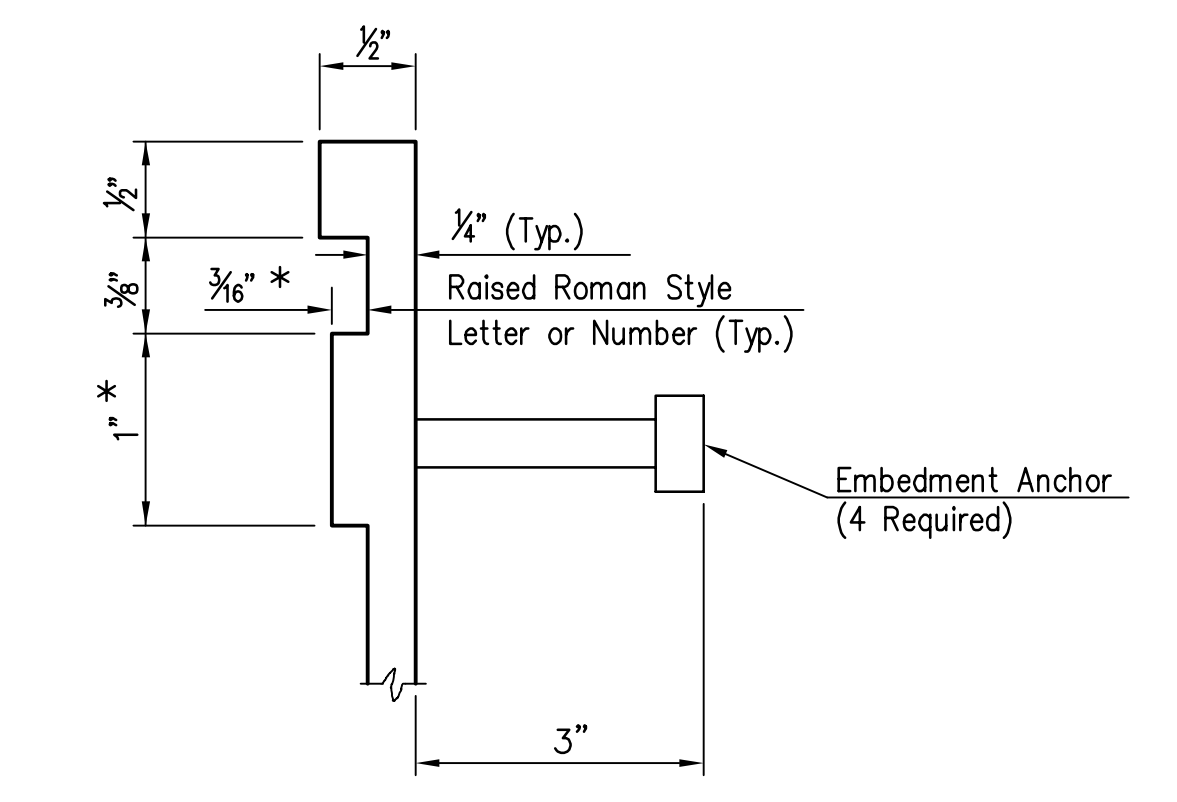
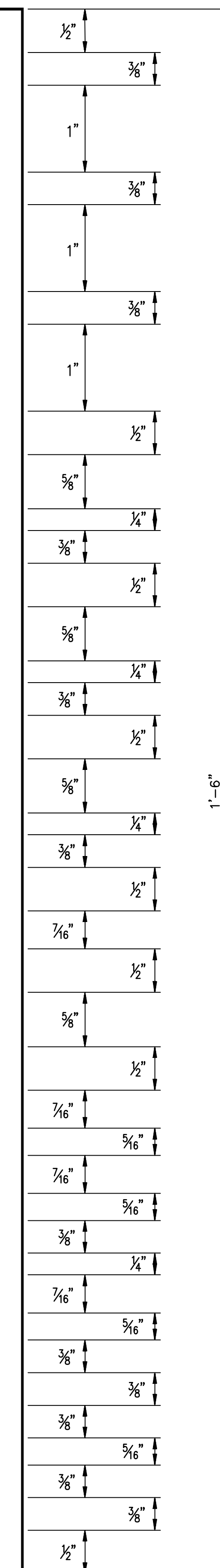
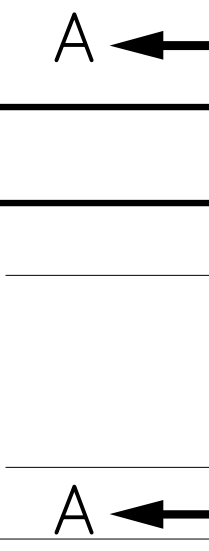

NOTES:
 * Variance of dimensions from Section 1625-Standard Specifications, 2015 Edition, Kansas Department of Transportation.
 Marker to be furnished and installed by the Contractor, SUBSIDIARY to the bid item "Concrete (Grade 4.0)(AE)(**)" (2 Required).
 See Sheet No. SheetNumber for location.
 ** Aggregate as specified in Division 1100, if applicable.

11/2017	Chg. bridge marker note & design specification.	LTP /DJS
3/2015	Chg. Design Load to HL-93	JSB /LP
3/2008	Chg. Spec to 2007 Edition	DRS /DVR
Date	Description	By /Chk

#####

BRIDGE PROJECT MARKER

STRUCTURE NO. XXX-XX-XXXX (B-XXX) STA. 00+00.00

PREPARED BY
 SEDGWICK COUNTY PUBLIC WORKS
 HIGHWAY DEPARTMENT

LYNN T. PACKER, P.E. DIRECTOR/COUNTY ENGINEER

SCALE	DESIGNED	DRAWN	CHECKED	SHEET NO.
	D.V.R.		L.T.P.	#####
DATE				

DWG: Bridge Project Marker-large.dwg

