

ADDENDUM NO. 1

**Sedgwick County Project: Charlotte Pipe Addition
Left Turn Lane Improvements**

The items contained herein now become a part of the referenced plans and specifications. Please read the following items and acknowledge receipt of this addendum on the Proposal Page Number P-1. NOTE: THIS ADDENDUM MUST BE ACKNOWLEDGED TO CONSTITUTE A VALID BID.

SPECS AND/OR PLANS:

- Replace Sheet No. 7 with Sheet No. 7R.; Changed 6" concrete to 8" concrete in the Type I detail.

By:



Lynn T. Packer, P.E.
Director of Public Works/County Engineer

Date: March 25, 2025

J:\Projects\2021\2101040614_Sedgwick County_B502\00 210614 CAD\SHTS\05 Civil\ Pav\21614_entrance details.dwg

COUNTY	STATE	PROJECT NUMBER	FISCAL YEAR	SHEET NO.	TOTAL SHEETS
SEDGWICK	KANSAS		2025	7R	36

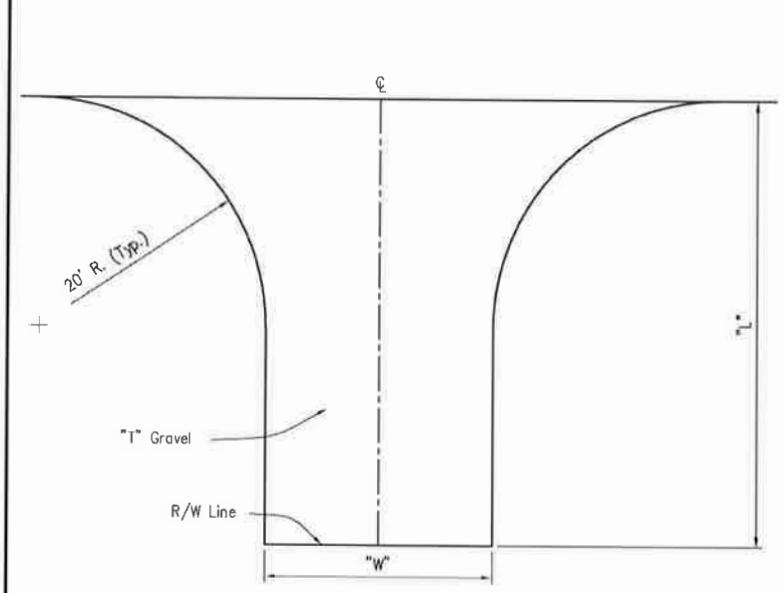

PLAN (TYPE IV)

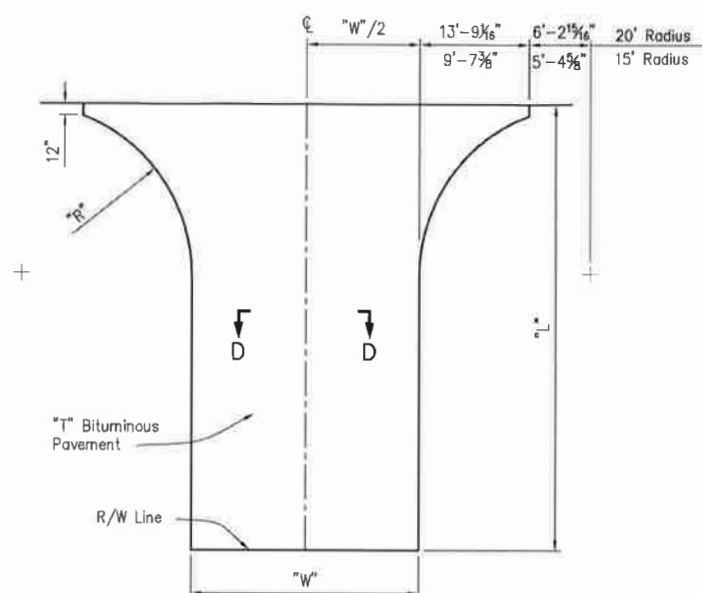

PLAN (TYPE III)

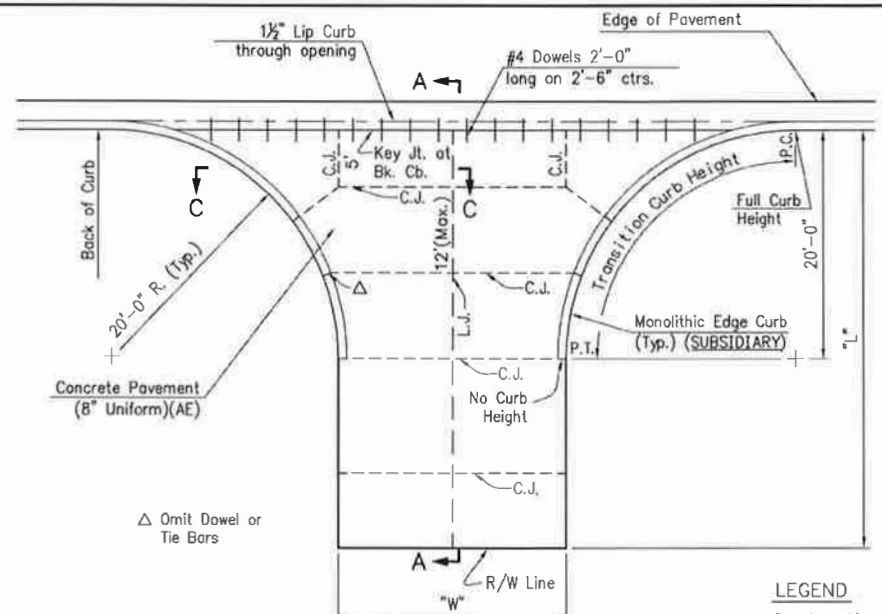

PLAN (TYPE II)

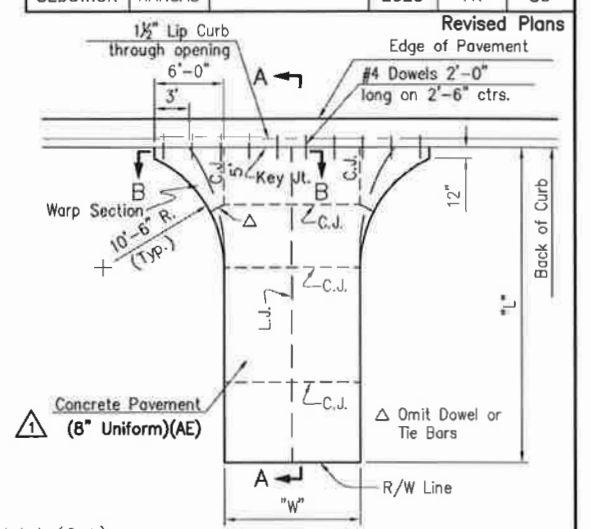

PLAN (TYPE I)
STA. 50+00.00 (LT.)

LEGEND
 - - - Contraction Joint (C.J.)
 - - - Longitudinal Joint (L.J.)

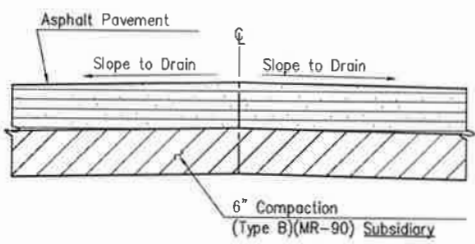

SECTION D-D

NOTE: On entrances which slope toward the highway, a low point shall be constructed in line with the highway ditch to divert surface drainage, unless otherwise shown on the plans.

See "Entrance Grading Plan" Sheet 6 for entrance grading and dimensions. See "Summary and Recapitulation of Quantities" Sheet 13 for quantities.

Notes for Concrete Entrances:

Grade 3.0 Concrete (AE) shall be used for Concrete Entrances. On concrete pavement projects, the Contractor may substitute the mix used in concrete pavement.

One longitudinal joint shall be constructed along the centerline of entrances having a "W" of 24' or less. Longitudinal joints shall be constructed at equal spacing not to exceed 10' for entrances having a "W" greater than 24'. The placement of these joints should aid in guiding vehicles entering and leaving the entrance.

Expansion and construction joints shall be constructed at equal spacing not to exceed 12'. Expansion joints shall be 5" of preformed Expansion Joint Filler (Nonextruding, Type B) and 1" of Hot or Cold poured Joint Sealing Compound.

One-half inch expansion joints shall be installed wherever drive construction abuts sidewalk or bike path. One-half inch expansion joints shall also be installed along the property line and/or back of walk line when drive construction along this line abuts concrete parking lots or concrete drive extension.

Dowel bars shall be omitted from the keyed construction joint along the back of curb when driveways are constructed in conjunction with new concrete pavement construction.

All entrances shall be a minimum of 6" in thickness and shall be reinforced with WWF 6x6-W4xW4.

Welded wire reinforcement and/or tie bars shall be placed using chairs to assure correct vertical placement.

NOTE: All entrance side slopes shall be 6:1 or flatter. The Contractor shall backfill around the edges of all pavements with suitable soil material as directed by the Engineer.

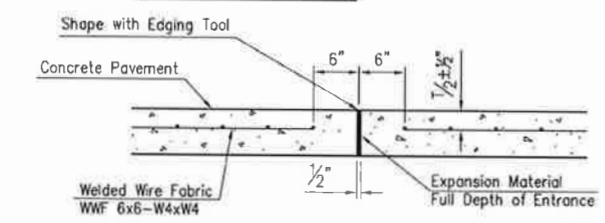

EXPANSION JOINT (E.J.)

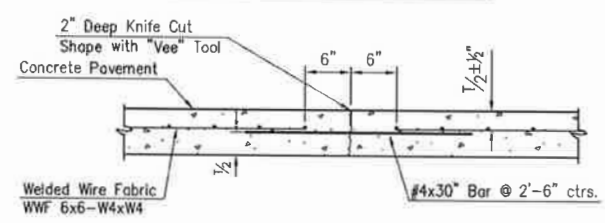

CONTRACTION JOINT (C.J.) or LONGITUDINAL JOINT (L.J.)

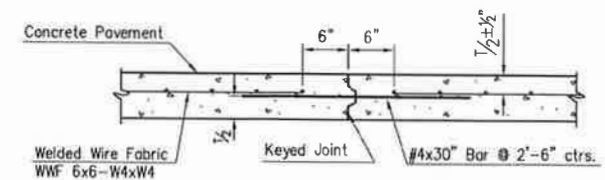

ALT. LONGITUDINAL CONSTRUCTION JOINT

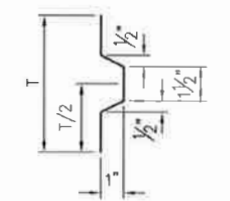

KEY WAY DETAIL

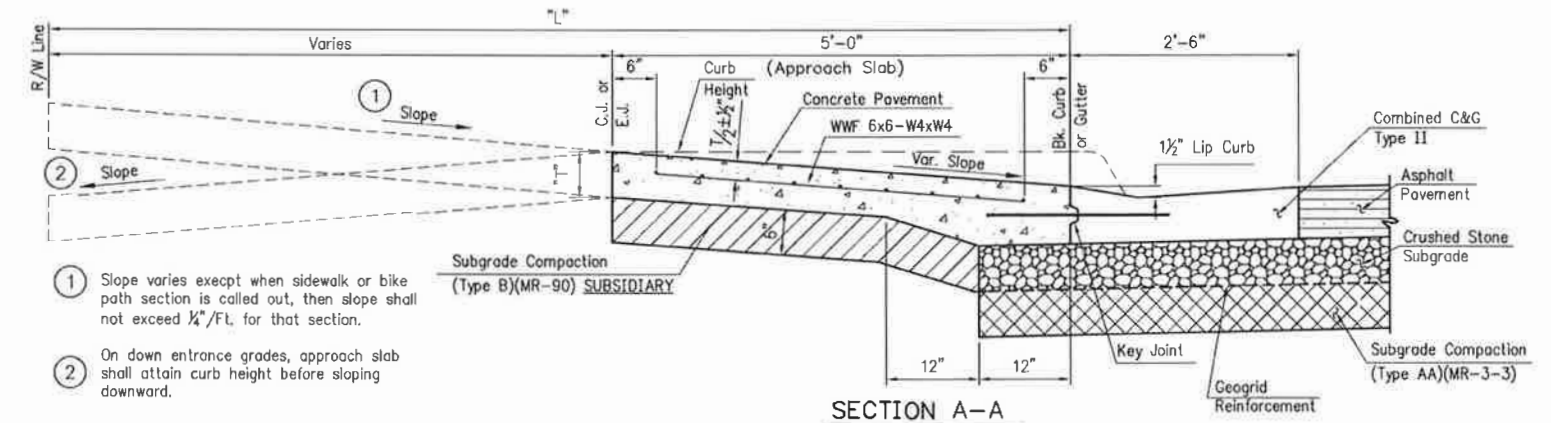

SECTION A-A

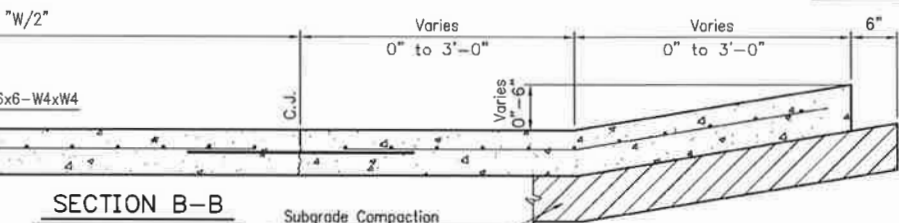

SECTION B-B

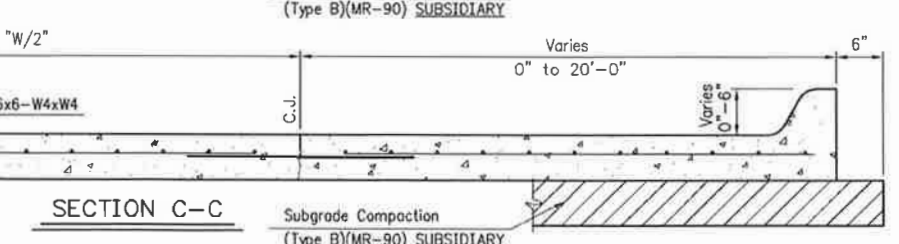

SECTION C-C

3/21/2025 Clarification

ENTRANCE DETAILS

PREPARED BY SEDGWICK COUNTY PUBLIC WORKS HIGHWAY DEPARTMENT				
LYNN T. PACKER, P.E.			DIRECTOR/COUNTY ENGINEER	
SCALE	DESIGNED	DRAWN	CHECKED	SHEET NO.
	L.T.P.	D.R.S.	L.T.P.	7R
DATE	8/2006	9/2009	9/2009	



DWG 240165_entrance details.dwg